

# Installation instructions

## Langmatz optical fibre distribution and termination box M ONT M

### 1 Sicherheitshinweis



- These installation instructions are addressed to technically trained expert personnel.
- The applicable regulations for accident prevention and handling optical fibres are to be observed!



- Please note the possibility of laser radiation in the non-visible spectrum!
- Never look into open fibre ends

### 2 Technical data

Dimensions H x W x D:	242 x 163 x 46 mm
Total weight:	approx. 0.5 kg
Housing material:	Plastic – Polycarbonate (PC)
Housing colour:	Light grey RAL7035
Protection rating:	IP54
Impact Protection (IK) Rating:	IK06

### 3 Scope of delivery and screw connection points

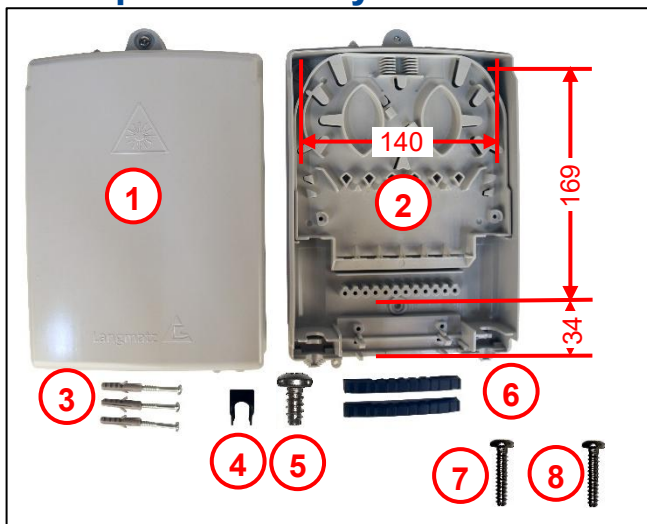

Fig. 1

Dimensions for screw connection points as shown in Fig. 1.

**Item 1** 1x housing cover and fastening screw

**Item 2** 1x housing with adaptor mounting support and crimp splice protector storage, 12-splices

Not depicted:

Design with heat shrink splice protector storage, 12-splices

**Accessories:**

**Item 3** 3x fastening screws with dowel for wall installation

**Item 4** 1x retainer clip for micropipe

**Item 5** 1x notched screw

**Item 6** 2x sealing grommets for cable outlet

**Item 7** 1x Cover screw Phillips head

**Item 8** 1x Cover screw Torx

## 4 Housing installation

### 4.1 Preparation

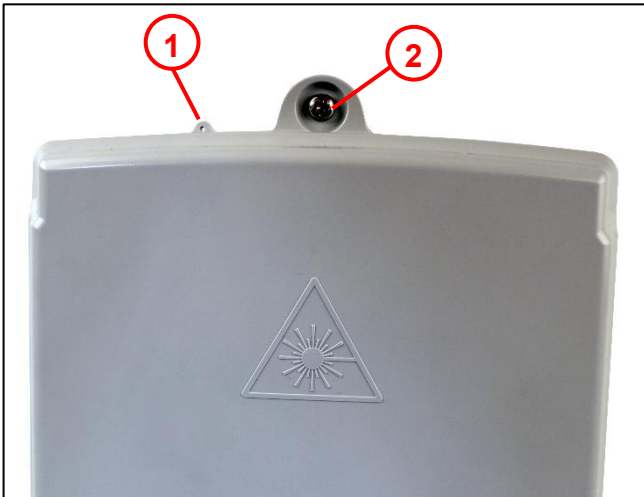

Fig. 2

- Choose cover screw as desired from accessory pack **(2)**. If necessary, an M4x20 grooved screw can also be used here.
- Flip open the housing cover.
- Mount the housing onto the wall. Before drilling holes beware of existing utilities (gas, water, electricity). Refer to Fig. 1 for the provided mounting holes.
- After the housing has been closed again, there is the option of installing a security seal using the pre-formed tab **(1)**.



Fig. 3

- There are two tabs **(1)** on the underside of the housing for the option of attaching a cord. Doing so ensures that the housing cover is attached to the housing and thus can't be lost.

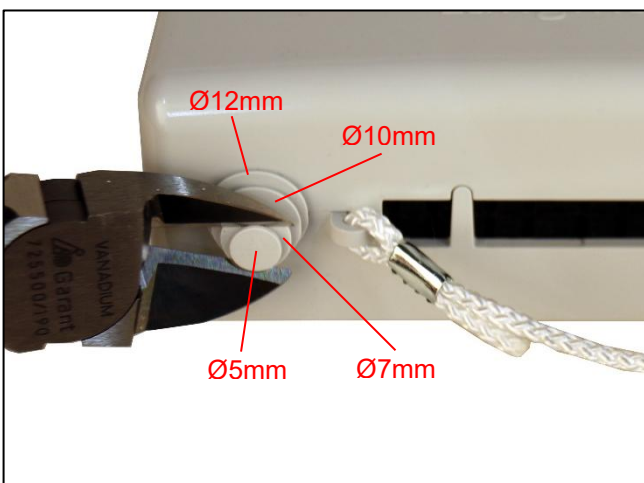

Fig. 4

- To feed in the micropipe, open up the appropriate diameter at the set break point using a suitable tool.
- For diameter dimensions, refer to Fig. 4

## 4.2 Inserting the micropipe

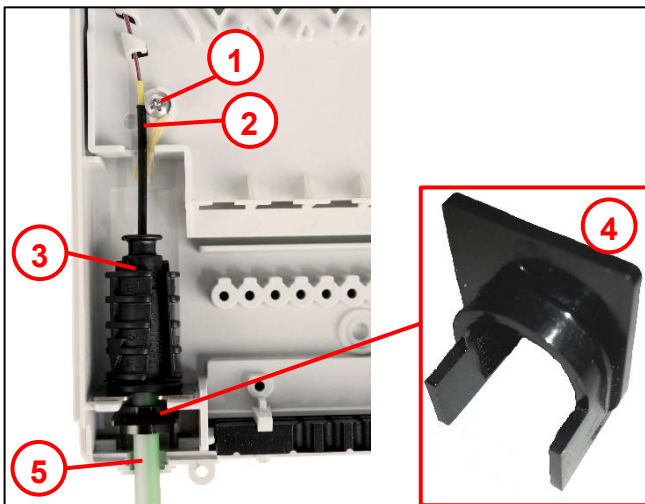

Fig. 5

- Cut the micropipe (5) to the appropriate length for the gas blocker (3) which is being used.
- Strip an appropriate length of the fibre optic cable (2).
- Insert the retainer clip (4) for fixing the micropipe in place into the recess provided for this purpose. **Note:** Spacer struts (Fig. 5) should face towards opening.
- Establish cable strain relief:
  - Shorten exposed aramid yarn to 100mm.
  - Fasten aramid yarn to the housing using the notched screw provided (1).
  - Carefully cut off any protruding aramid yarn.

## 4.3 Inserting the adaptors (without a splitter)

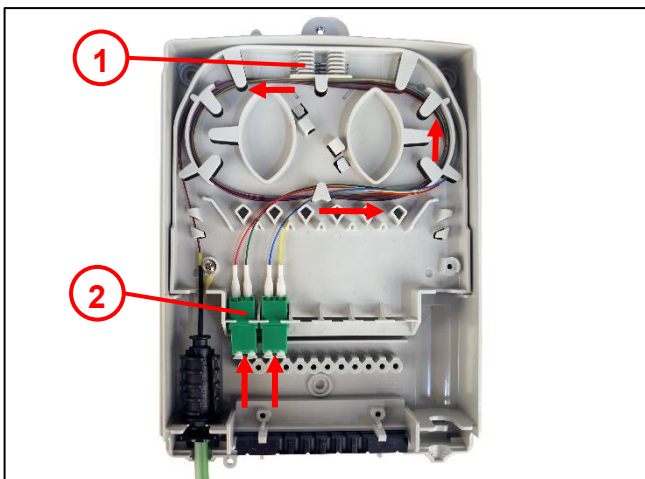

Fig. 6

- Insert the adaptors without a flange (SC simplex/LC duplex) (2) into the available mounting supports from underneath.
- If the micropipe is inserted on the left side, the pigtails need to be routed into the excess length storage on the right side.
- Store the crimp splice protector in the crimp splice protector storage in two stacked levels (1).
- For designs with heat shrink splice protectors, store in the heat shrink splice protector storage in three stacked levels.
- **Note:** If the micropipe is inserted on the right side, the setup should be a mirror image.

## 4.4 Inserting the adaptors (with a splitter)

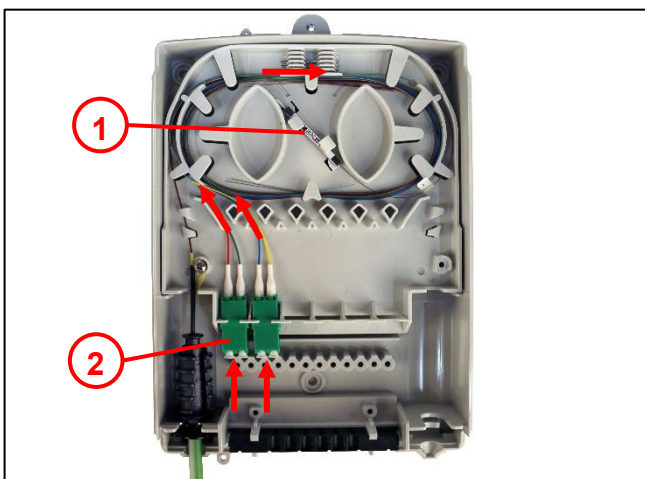

Fig. 7

- Insert the adaptors without a flange (SC simplex/LC duplex) (2) into the available mounting supports from underneath.
- If the micropipe is inserted on the left side, the pigtails need to be routed into the excess length storage on the left side.
- Store the splitter (1) in the fixture provided.
- Proceed with the crimp splice protector/heat shrink splice protector as shown in item 4.3.
- **Note:** If the micropipe is inserted on the right side, the setup should be a mirror image.

## 4.5 Inserting the rubber grommets

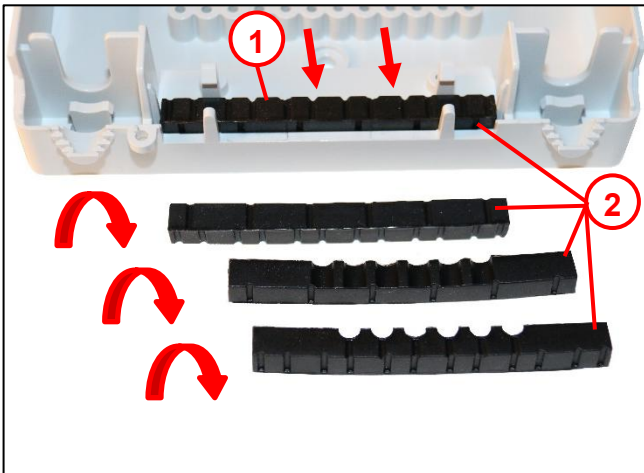

Fig. 8

- Insert 2x rubber grommets (1) into the fixture provided.
- Rotate the rubber grommets by 90° each for different cable diameters (see example in Fig. 8).

**Note:** The rubber grommets must always be inserted in such a way that the continuous sealing barrier (2) faces outwards.

## 5 Optical fibre subscriber junction box

**Note:** LC duplex adapters without flange, **but with shutter**, must be used.

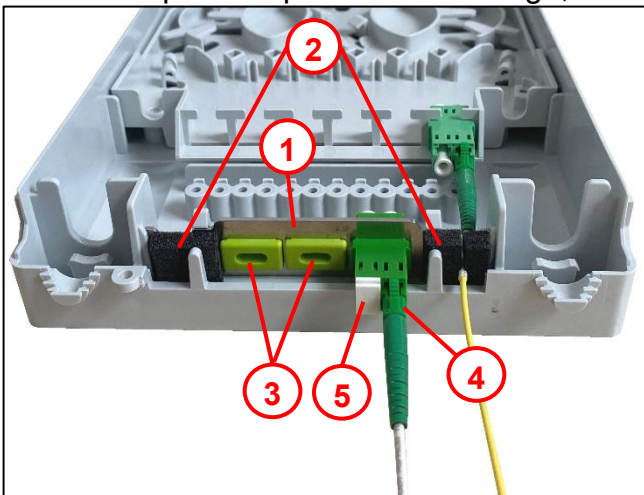

Fig. 9

- Snap the coupling adapter (1) into the bottom part.
- Insert the sealing block (2) left and right for standard adapters.
- Insert the sealing plug (3) or LC/APC duplex (4) shutter adapter.

**Note!**

The shutter side (5) must be inserted facing outwards.

## 6 Accessories

Item	Name	Article number	Image
1	Accessories kit for 5 mm in-house cable (strain relief/grommet insert/pressure plate/notched screws)	064400501	
2	Accessories kit, direct in-house cable connection for fastening the aramid yarn (12 x notched screws)	064400502	
3	Accessories kit, retainer clip/strain relief screw	064400503	
4	Accessories kit (strain relief for micropipe) Ø 7 mm Ø 10 mm Ø 12 mm Packaging unit: 10 units each see <a href="#">installation instruction strain relief panel</a>	064400505 064400506 064400507	

## 7 Disposal/recycling

At the end of the service life, the optical distribution and termination box must be recycled and/or disposed of according to the applicable statutory regulations.

D-82455 Garmisch-Partenkirchen

Telephone: +49 (0)8821 920-0

E-mail: [info@langmatz.de](mailto:info@langmatz.de)

**[www.langmatz.de](http://www.langmatz.de)**

Our hotline: +49 (0)8821 920 137

70 083 0800 / 001 | Last updated: 28.05.2026